

<- Back

Forward ->

Document ID# 217398
2000 Chevrolet/Geo Corvette

Print

Fascia Replacement - Front Bumper

Removal Procedure

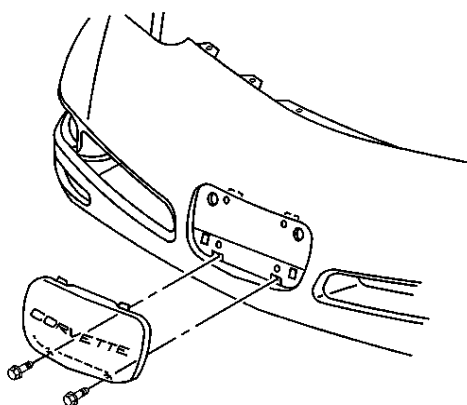

1. Remove the front license plate.

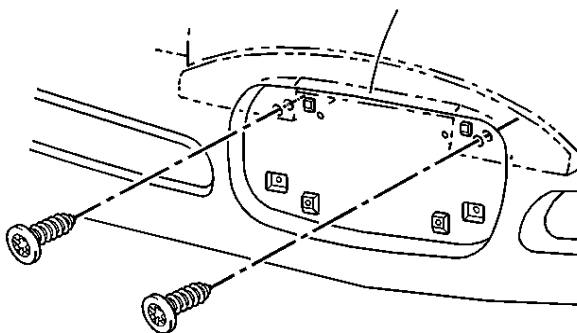

Important

Use only the exact size square headed tool when removing or installing the plastic headed screws to avoid stripping the screw heads.

2. Remove the plastic headed screws attaching the fascia license plate opening to the absorber.
3. Raise the vehicle and suitably support. Refer to [Lifting and Jacking the Vehicle](#) in General Information.

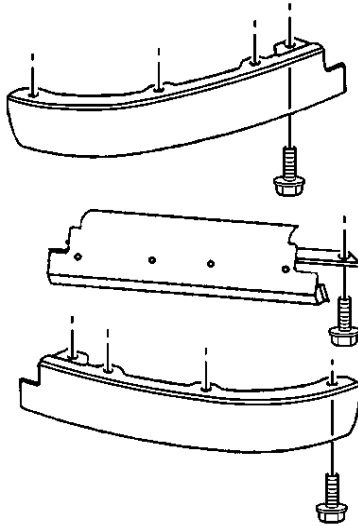

4. Remove the air deflector and the left and right outer valance.

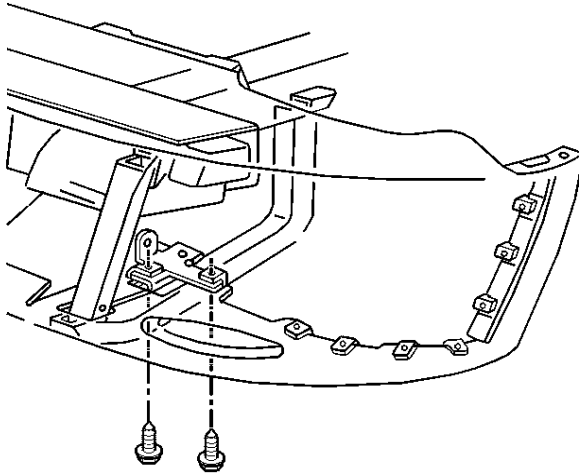

5. Remove the bolts attaching the fascia to the skid bar.

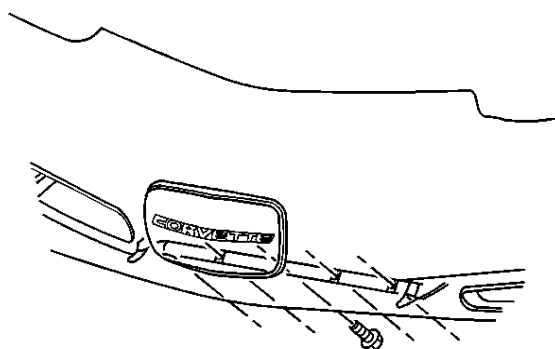

6. Remove the bolts attaching the fascia to the radiator support.

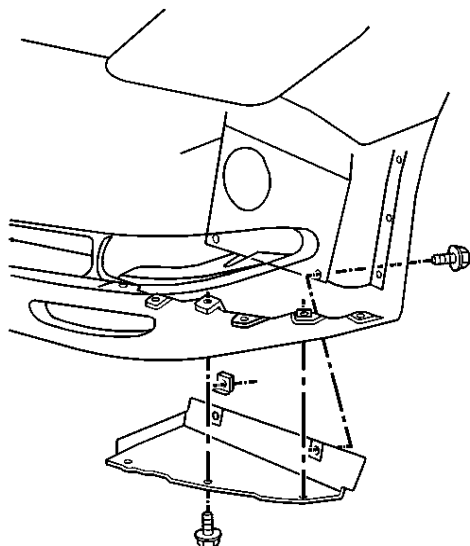

7. Remove the fascia lower close out panels.

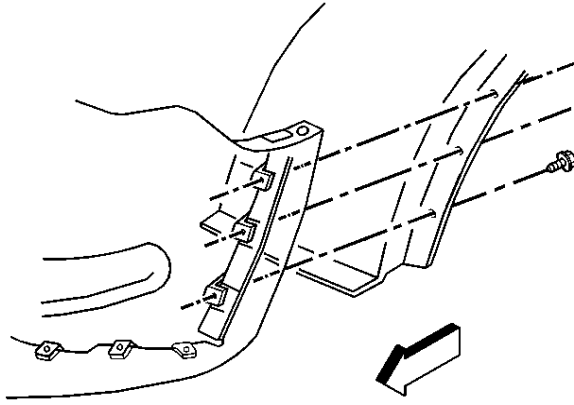

8. Remove the bolts attaching the wheelhouse panel to the fascia.
9. Remove the horns with bracket from the skid bar, if necessary, to gain access to the fascia harness connector.

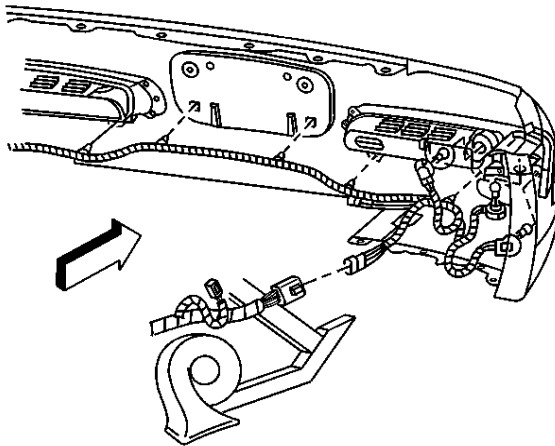

10. Disconnect the fascia harness connector.

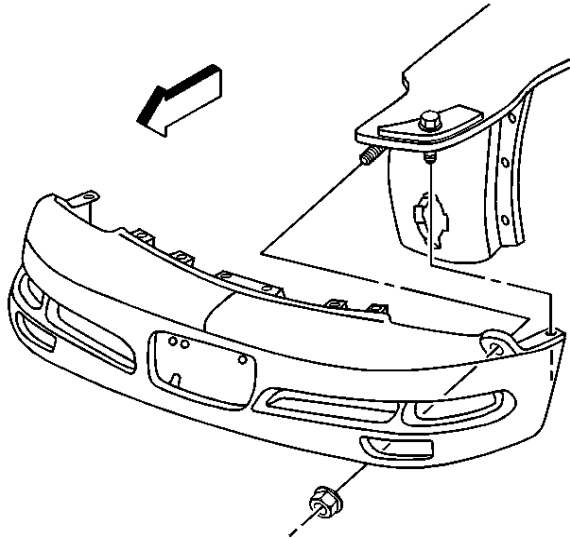

11. Remove the nuts from the fender reinforcement studs.

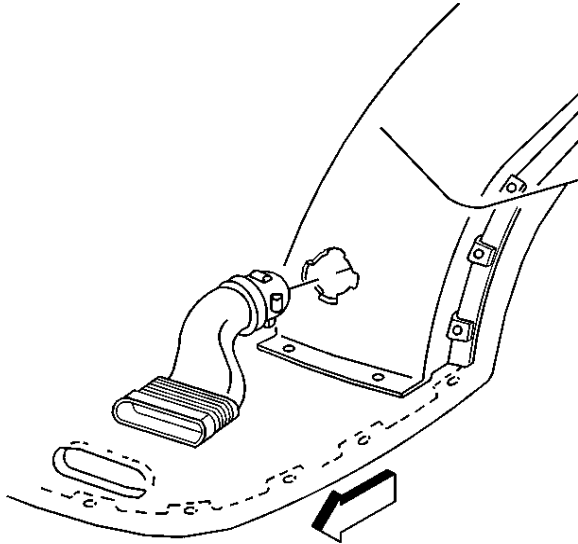

12. Disconnect the front brake caliper cooling ducts from the fascia. Pull the fascia outward slightly to release the tension between the ducts and the fascia.
13. Lower the vehicle.

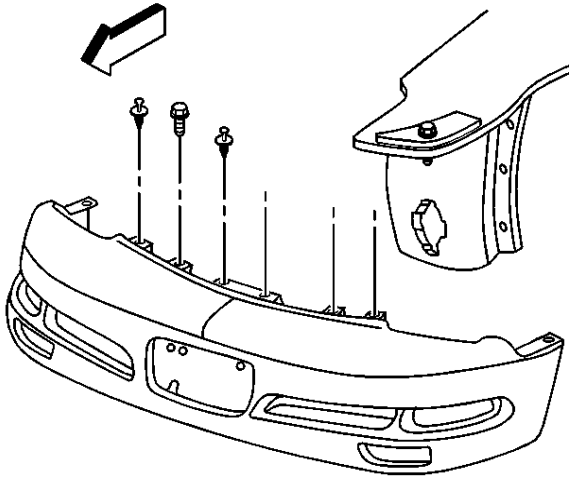

14. Remove the push-pins and bolts attaching the fascia upper flange to the fascia retainer.
15. Remove the fascia.
16. Transfer parts as necessary.

Installation Procedure

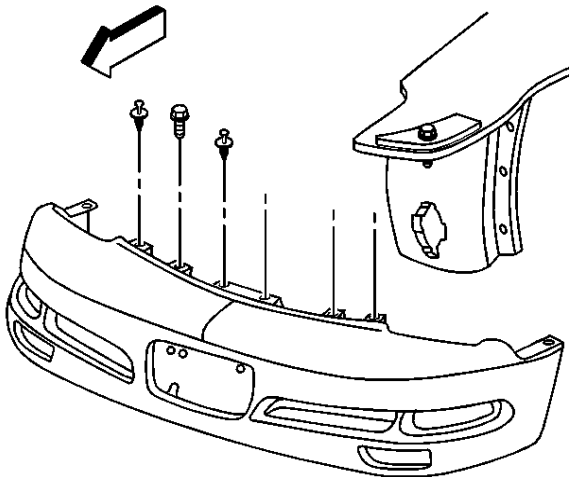

1. Position the fascia to the front of the vehicle.
2. Secure the upper flange of the fascia to the fascia retainer with the push-pin retainers.

Notice

Use the correct fastener in the correct location. Replacement fasteners must be the correct part number for that application. Fasteners requiring replacement or fasteners requiring the use of thread locking compound or sealant are identified in the service procedure. Do not use paints, lubricants, or corrosion inhibitors on fasteners or fastener joint surfaces unless specified. These

coatings affect fastener torque and joint clamping force and may damage the fastener. Use the correct tightening sequence and specifications when installing fasteners in order to avoid damage to parts and systems.

3. Install the bolts securing the upper flange to the fascia retainer. **Tighten**

Tighten the front fascia upper flange bolts to 5 N·m (44 lb In).

4. Raise the vehicle and suitably support. Refer to [Lifting and Jacking the Vehicle](#) in General Information.

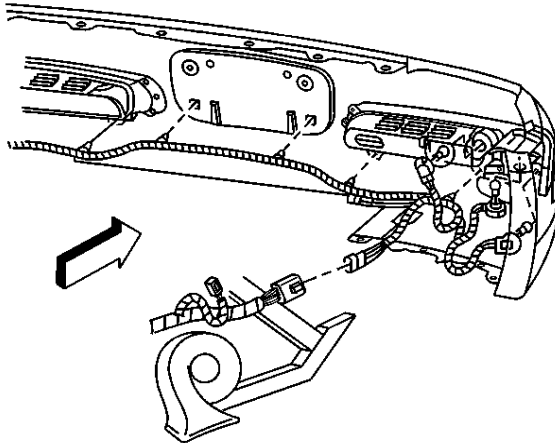

5. Connect the fascia harness connector.
6. Install the horns with bracket to the skid bar, if removed for access to the fascia harness connector.

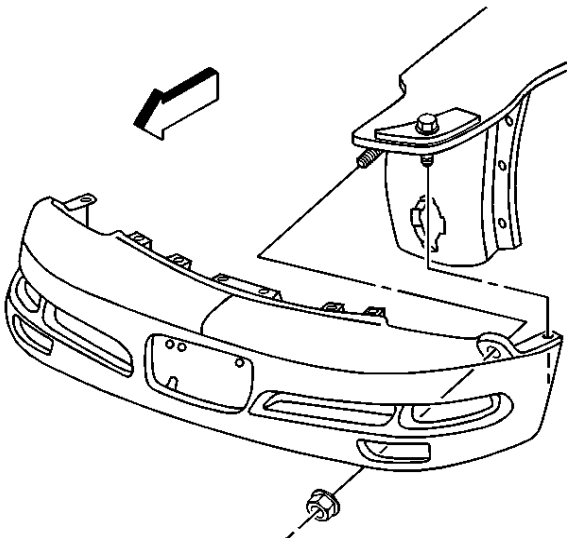

7. Align the fascia to the fenders at the headlamp opening and flush the fender to the vertical joint.
8. Install the nuts attaching the fascia to the forward studs on the right and left fender

reinforcements. **Tighten**

Tighten the front fascia to the fender reinforcement stud nuts to 5 N·m (44 lb in).

9. Align and flush the fascia to the fender at the horizontal joint.
10. Install the nuts attaching the fascia to the rearward studs on the right and left front fender reinforcement. **Tighten**

Tighten the front fascia to the fender reinforcement stud nuts to 5 N·m (44 lb in).

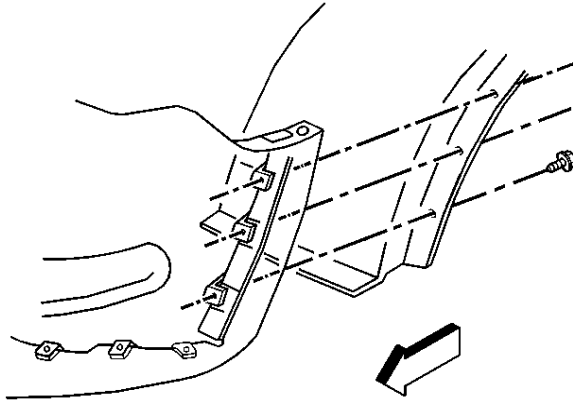

11. Install the bolts attaching the wheelhouse to the fascia. **Tighten**

Tighten the front wheelhouse to fascia bolts to 2.5 N·m (22 lb in).

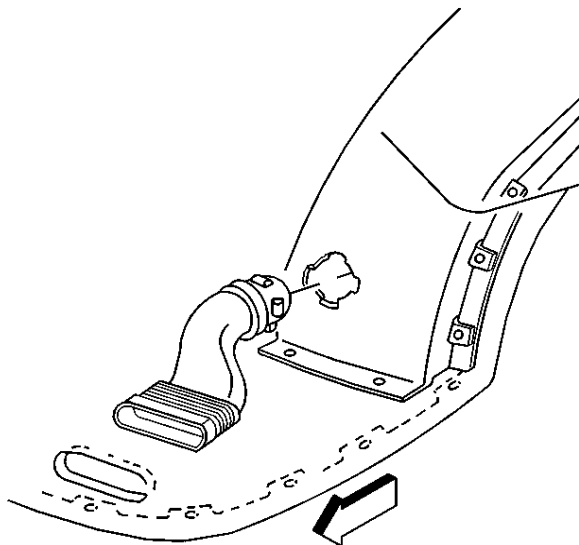



12. Install the brake caliper cooling ducts to the fascia. Refer to [Brake Caliper Cooling Duct Replacement - Front](#) .

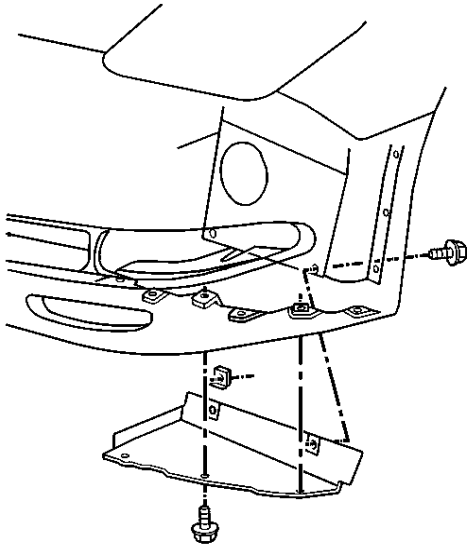

13. Install the fascia close out panels. Refer to [Close Out Panel - Front Bumper Fascia Lower](#) .
Tighten

Tighten the front fascia lower close out panel bolts to 7 N·m (62 lb in).

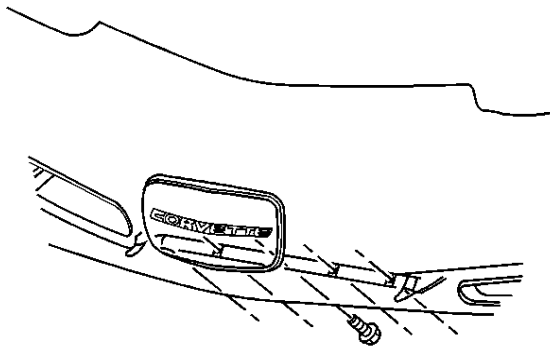

14. Install the screws attaching the lower fascia flange to the radiator support. **Tighten**

Tighten the front fascia lower flange to the radiator support screws to 8 N·m (71 lb in).

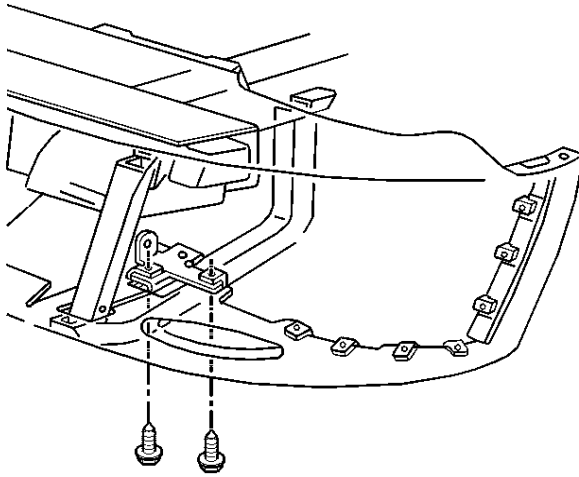

15. Install the bolts attaching the fascia to the skid bar bracket. **Tighten**

Tighten the front fascia to the skid bar bracket bolts to 2.5 N·m (22 lb in).

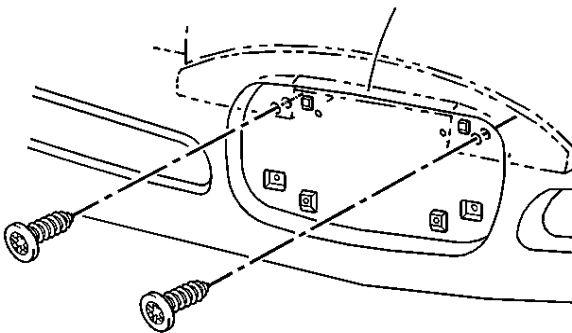

Important

Use only the exact size square headed tool when removing or installing the plastic headed screws to avoid stripping the plastic screw heads.

16. Install the plastic headed screws attaching the license plate opening to the absorber. **Tighten**

Tighten the license plate opening to absorber screws to 1 N·m (9 lb in).

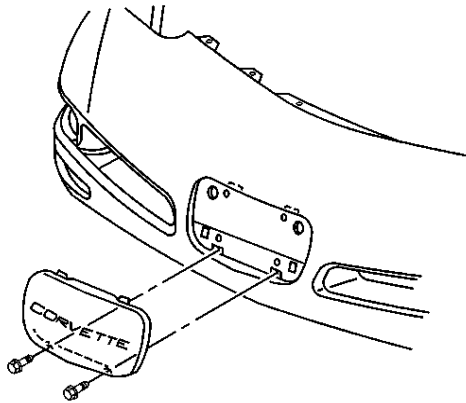

17. Install the license plate or the insert.
- A. Insert the upper tabs into the slots in the fascia.
 - B. Secure the insert or the plate with the screws.

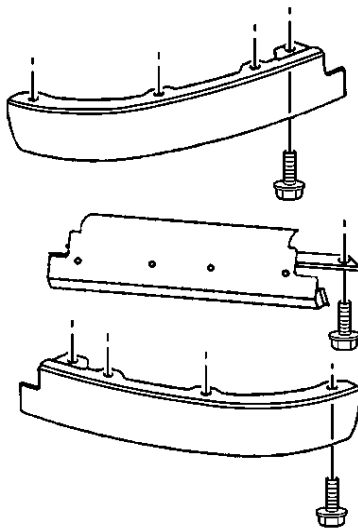

18. Install the air deflector. Refer to [Air Deflector Replacement - Front Bumper Fascia](#) . **Tighten**
- Tighten the air deflector screws to 7 N·m (62 lb in).

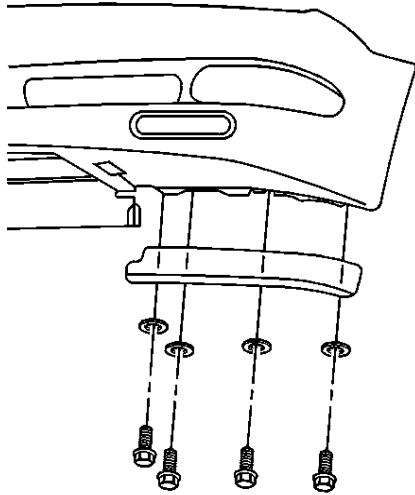

19. Install the right and left outer valance. Refer to [Valance Panel Replacement - Front](#) . **Tighten**
Tighten the outer valance screws to 7 N·m (62 lb in).
20. Lower the vehicle.

[<- Back](#)[Forward ->](#)

Document ID# 217398
2000 Chevrolet/Geo Corvette

[Print](#)