

<- Back

Forward ->

Document ID# 218197
2000 Chevrolet/Geo Corvette

Print

Fender Replacement - Front

Removal Procedure

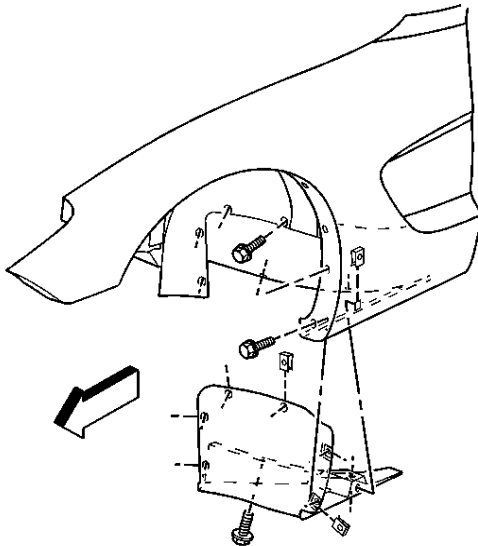

1. Raise the vehicle and suitably support. Refer to [Lifting and Jacking the Vehicle](#) in General Information.
2. Remove the tire and wheel. Refer to [Tire and Wheel Removal and Installation](#) in Tires and Wheels.
3. Remove the wheelhouse filler panel.

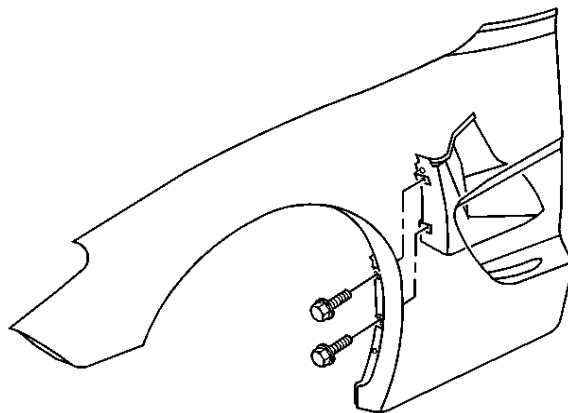



4. Remove the rear inner panel.

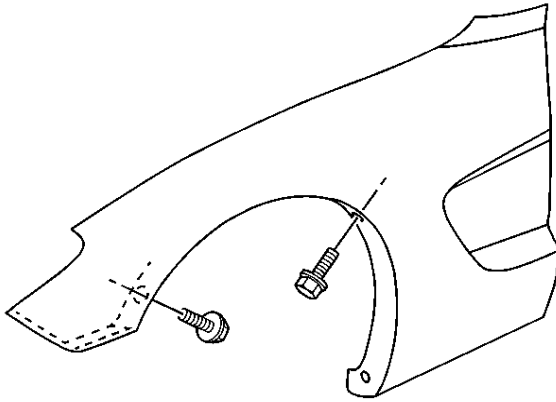

5. Remove the bolts attaching the fender opening to the wheelhouse.

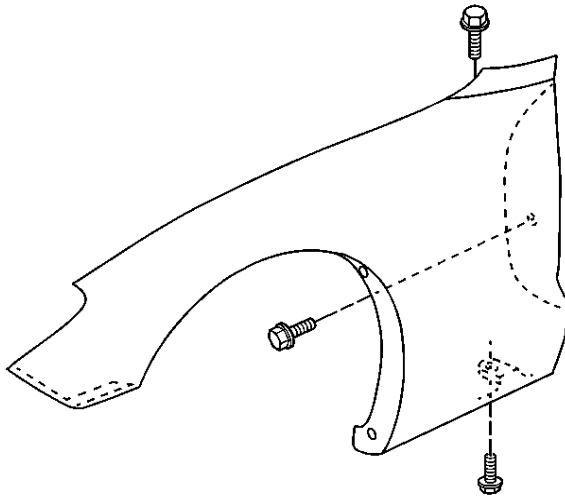

6. Remove the bolt attaching the fender to the rocker panel.
7. Remove the bolt attaching the fender rear center flange to the hinge pillar.

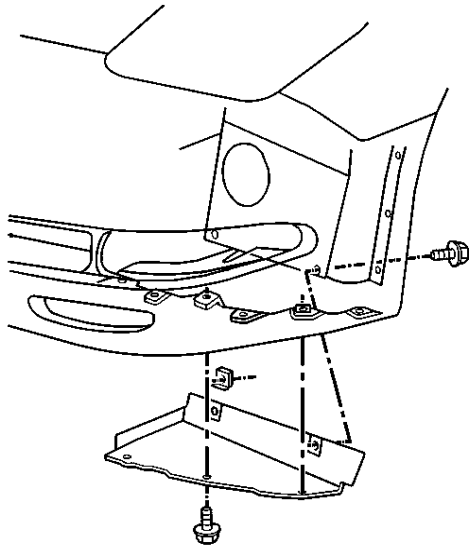

8. Remove the fascia front close-out panel. Refer to [Close Out Panel - Front Bumper Fascia Lower](#) in Bumpers and Fascias.

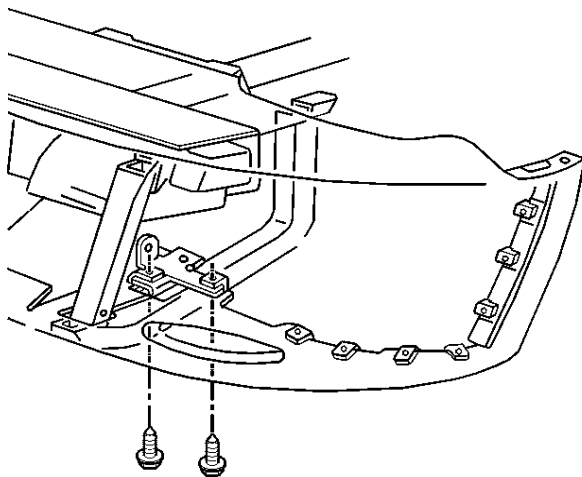

9. Remove the bolts attaching the fascia to the skid bar.
10. Remove the headlamp housing. Refer to [Headlamp Capsule Replacement](#) in Lighting Systems.
11. Lower the vehicle.

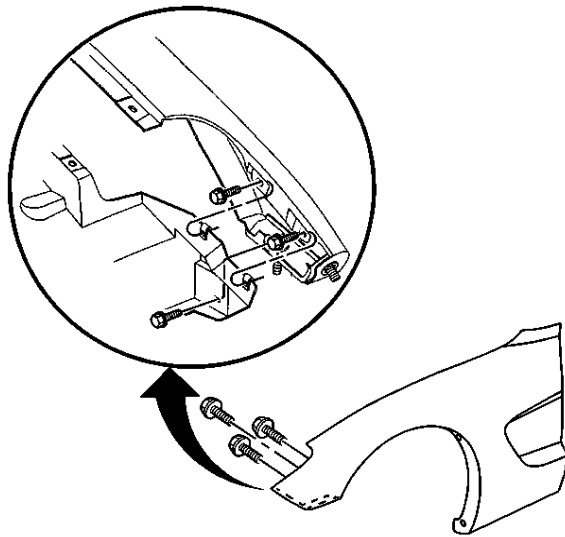

12. Remove the bolts attaching the fender to the wheelhouse upper front flange.

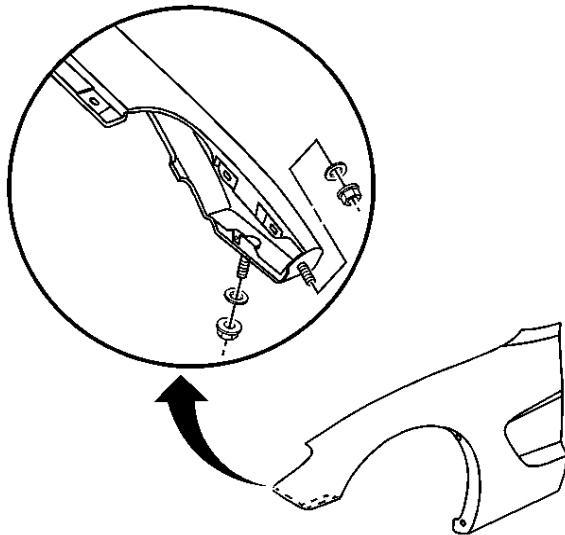

13. Remove the nuts attaching the fascia to the fender reinforcement studs.

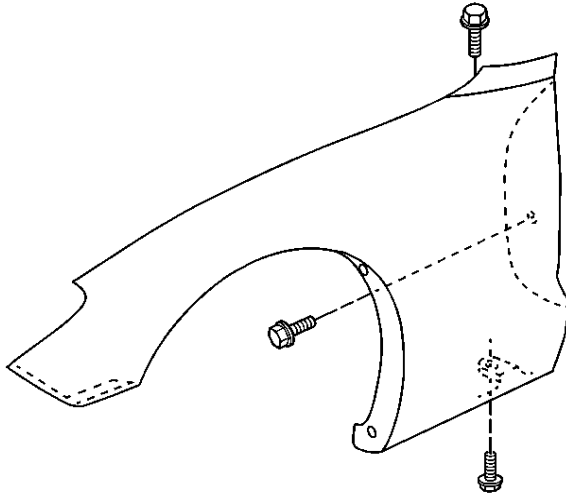

14. Remove the bolt attaching the fender to the upper hinge pillar fender bracket.

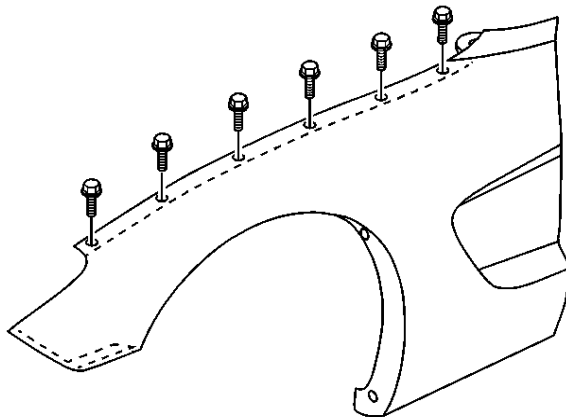

15. Remove the screws attaching the fender to the upper wheelhouse flange.
16. Remove the fender.
17. Transfer parts as necessary.

Installation Procedure

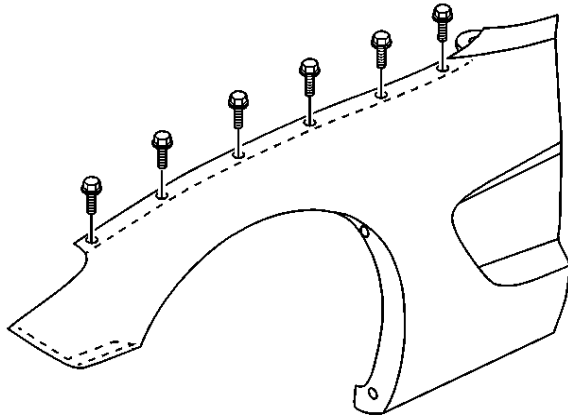

1. Position the fender with the fender reinforcement to the vehicle.

Notice

Use the correct fastener in the correct location. Replacement fasteners must be the correct part number for that application. Fasteners requiring replacement or fasteners requiring the use of thread locking compound or sealant are identified in the service procedure. Do not use paints, lubricants, or corrosion inhibitors on fasteners or fastener joint surfaces unless specified. These coatings affect fastener torque and joint clamping force and may damage the fastener. Use the correct tightening sequence and specifications when installing fasteners in order to avoid damage to parts and systems.

2. Starting at the rearmost hole, install the screws attaching the fender to the wheelhouse upper flange. **Tighten**

Tighten the fender to upper flange screws to 1.9 N·m (17 lb in).

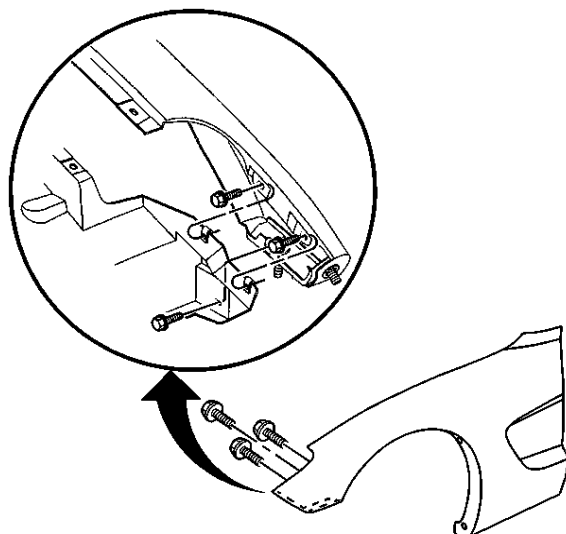



3. Install the screws attaching the fender to the wheelhouse upper front flange. **Tighten**

Tighten the fender to upper front flange screws to 1.9 N·m (17 lb in).

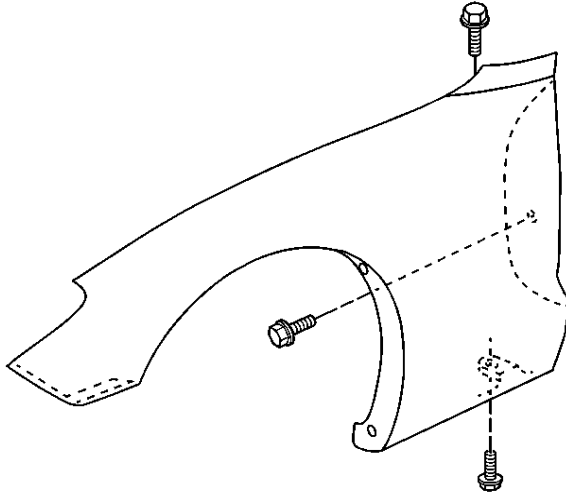

4. Install the screw attaching the fender to the upper hinge pillar fender bracket. **Tighten**

Tighten the fender to the upper hinge pillar bracket screw to 3.5 N·m (31 lb in).

5. Install the screw attaching the fender's rear center flange to the hinge pillar. **Tighten**

Tighten the fender to center flange screw to 10 N·m (89 lb in).

6. Install the screw attaching the bottom of the fender to the rocker panel. **Tighten**

Tighten the fender to the rocker panel screw to 2.8 N·m (25 lb in).

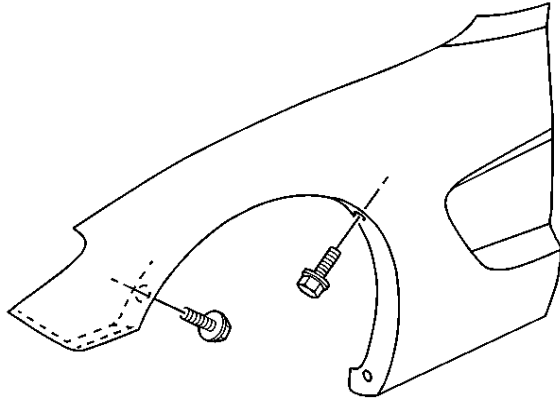

7. Install the screws attaching the fender opening to the wheelhouse. **Tighten**

Tighten the fender to the wheelhouse wheel opening screws to 3 N·m (26 lb in).

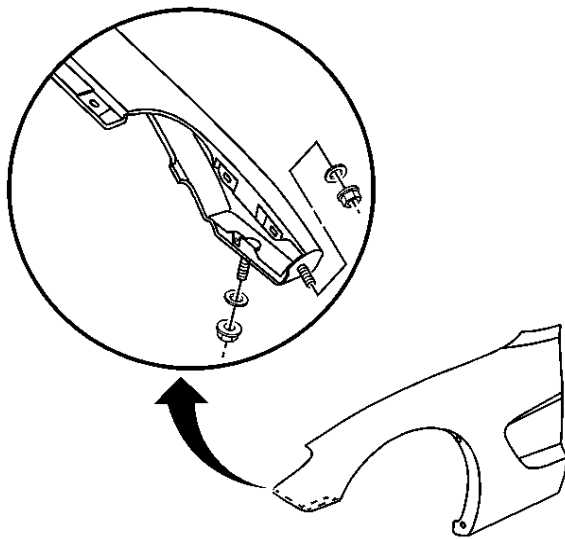

8. Align the fender to the front fascia.
9. Install the nuts attaching the front fascia to the fender reinforcement studs. **Tighten**

Tighten the fascia to the fender reinforcement stud nuts to 7 N·m (62 lb in).

10. Install headlamp housing. Refer to [Headlamp Capsule Replacement](#) in Lighting systems.

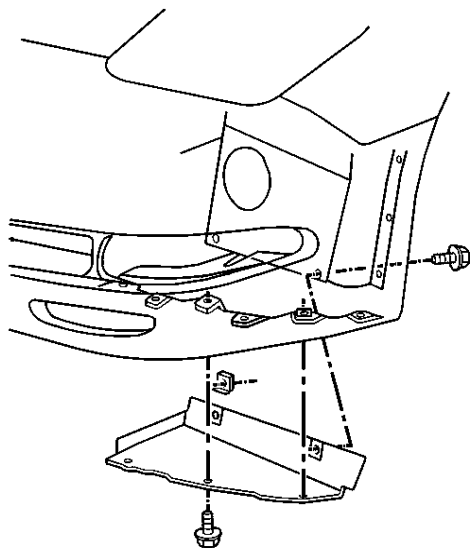

11. Install the front fascia close out panel. Refer to [Close Out Panel - Front Bumper Fascia Lower](#) in Bumpers and Fascias.

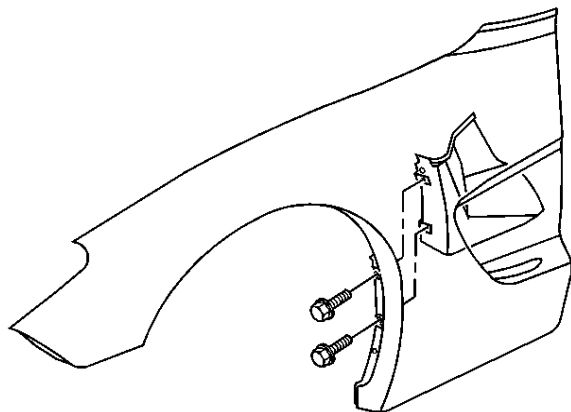

12. Install the rear inner panel. **Tighten**

Tighten the rear inner panel bolts to 1.9 N·m (17 lb in).

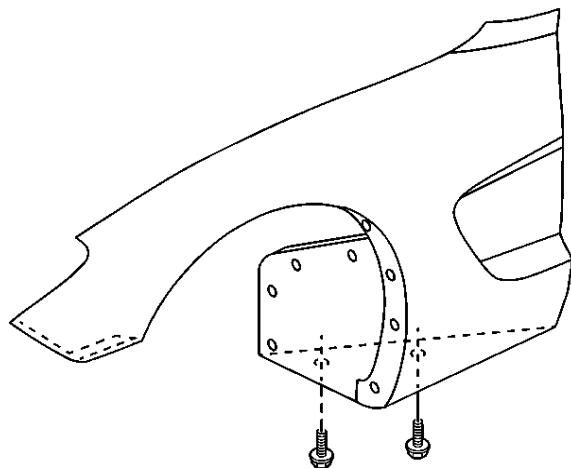

13. Install the wheelhouse filler panel.

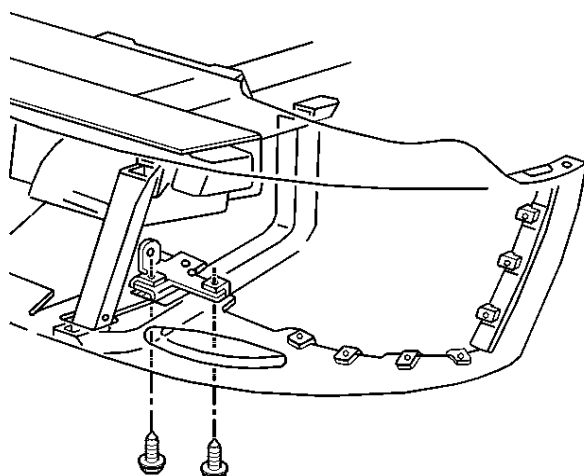

14. Install the fascia to skid bar bracket bolts. **Tighten**

Tighten the fascia to skid bar bracket bolts to 5 N·m (44 lb in).

15. Install the tire and wheel. Refer to [Tire and Wheel Removal and Installation](#) in Tires and wheels.

<- Back

Forward ->

Document ID# 218197
2000 Chevrolet/Geo Corvette

Print